

## TYPE: H-2/3A1200

### Specifications

Nominal Dimension : (with sleeve)	$\Phi = 16.8 \pm 0.2 \text{mm}$ $H = 28.5 \pm 0.5 \text{mm}$
Applications :	Recommended discharge current 120mA to 1200 mA
Nominal Voltage :	1.2V
Nominal Capacity* :	1200mAh when discharge at 240mA(0.2C) to 1.0V at 20°C
Standard Charge :	120mA(0.1C) for 15 hrs at 20°C
Fast Charge :	1200mA (1C) with charge termination control Recommended control parameters - $\Delta V$ :5mV & $\Delta T/\Delta t$ :0.8~1°C/min Timer: 120 % nominal input
Service Life :	> 500 cycles
Continuous Overcharge :	120mA maximum permissible current No conspicuous deformation and / or leakage
Weight** :	20g
Internal Resistance** :	Max 25m $\Omega$ at 1000Hz measured within 1 hour after standard charge
Max. Charging Voltage :	1.5V at 240mA(0.2C) charging
Ambient Temperature : Range	Standard Charge : 0°C to 45°C Fast Charge : 10°C to 45°C Discharge : -20°C to 45°C Storage : -20°C to 45°C

**Note:**

\*0.2C discharge capacity after charging at 0.1C for 15 hours.

\*\*Weight and internal impedance are for reference.

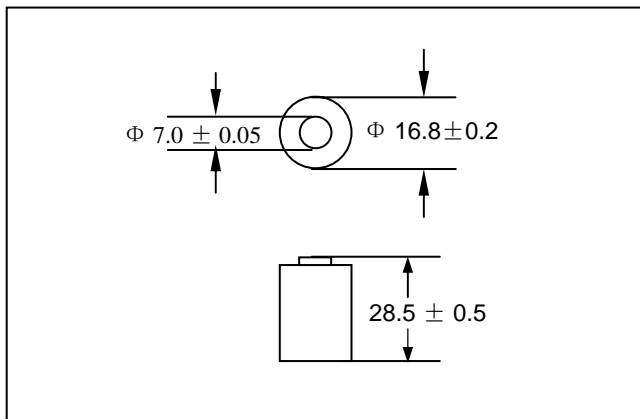

### Characteristics

#### Charge Curves ( 20°C )

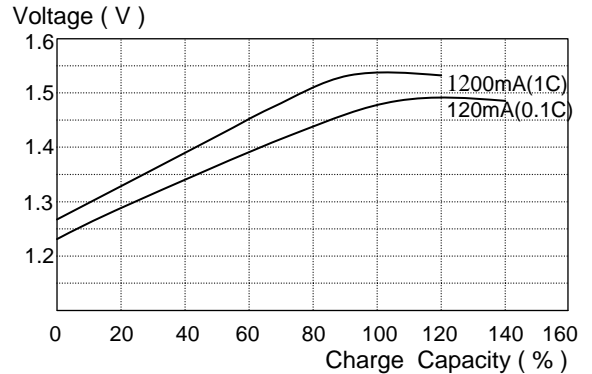

#### Discharge Curves ( 20°C )

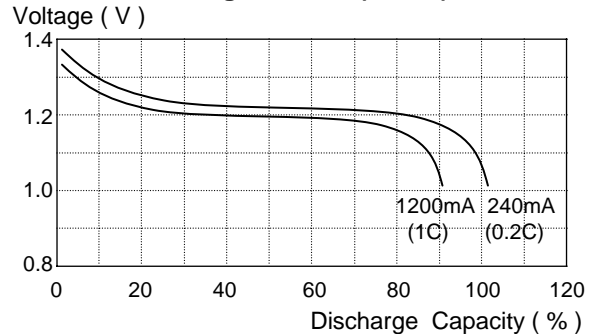

#### Temperature Characteristic

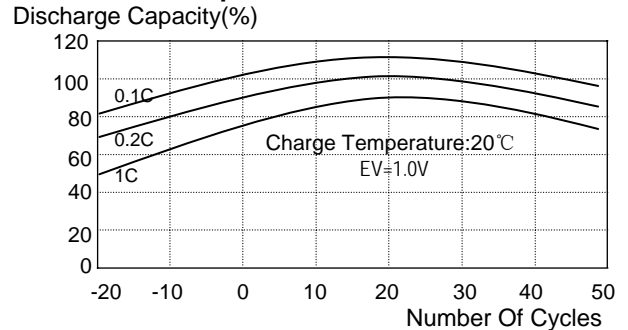

**American Toppower**

Add: 2033 Route 130, Unit N, Monmouth Junction, NJ 08852

Manufacturer reserves the right to alter or amend the design, model and specification without prior notice.